

# CONNJUNTO ( SERIES E )

Vinyl Resin

KALLOS CONNJUNTO ( KCME ) is an Control joints designed to allow localised movements that arise from drying shrinkage, thermal gain/loss and creep. kallos control joints sigtline insirt is vulcanised neobrene or EPDM.

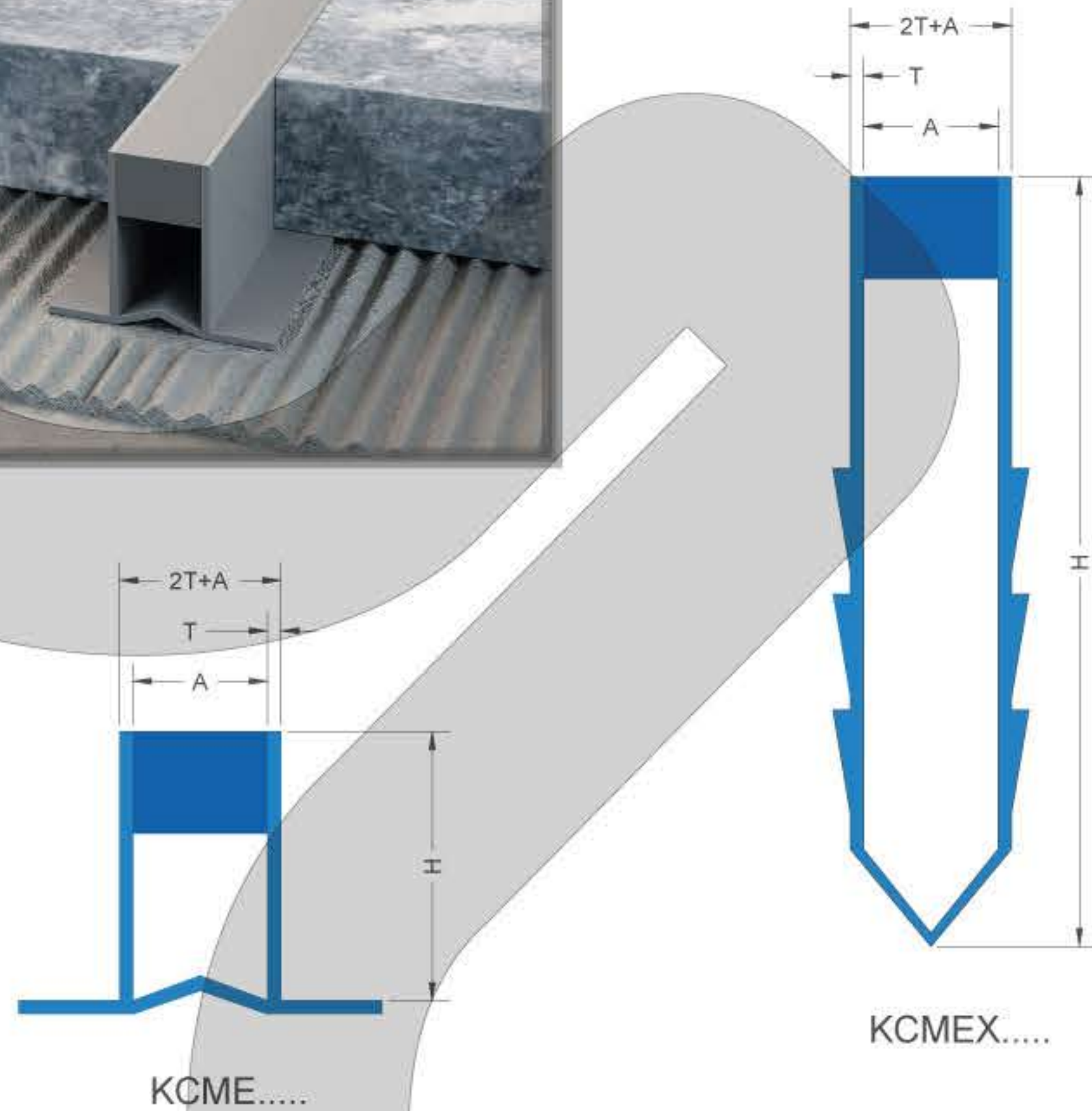
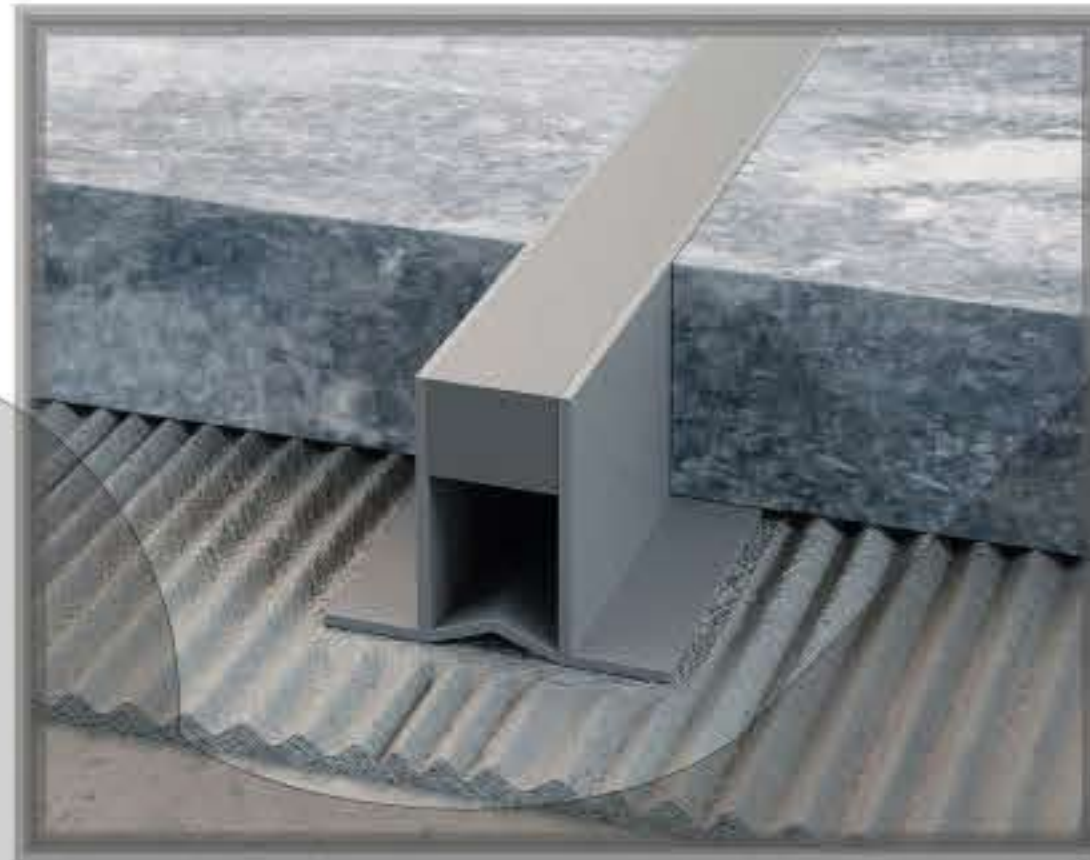

## Control Joint Dimentions

ARTICLE	HEIGHT H (mm)	THICKNESS T (mm)	SIGHTLINE A (mm)	LENGHT/PC (mm)	ORDER CODE
KCME	8,10,12 14,16,20	01	06	2.5	KCME-H
KCMEX	25,35,45	01	06	2.5	KCMEX-H

» When ordering specify the color of slightline.

## Colors



Dark grey  
for rigid and  
flexible part



Light grey  
for rigid and  
flexible part

## Laying instructions

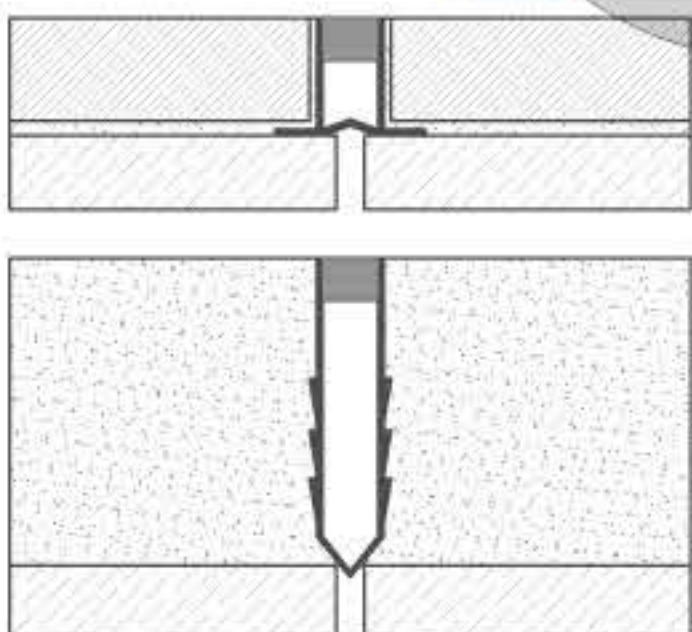

- 1 Select KCME width according to the desired.
- 2 Trowel tile adhesive over the area.
- 3 Press the KCME profile into place and align on top of the already laid tile.
- 4 Solidly embed the tiles so that the tiled surface is flush with the top of the profile, the profile should not be higher than the tiled surface.
- 5 Fill the joint completely with grout.

## Maintanance

To achieve the most favorable performance, please follow the maintenance instructions below.

» Regular maintenance of the Profile will help prolong the life of the product. A build up of dirt and grease can prove hazardous and also affect the appearance of the profile.

» Firstly, any excess dirt should be removed by using a quality vacuum cleaner or a soft bristle brush. A harsh bristle will mark the material.

» The profile should then be cleaned by using a soapless, neutral detergent in warm water on a damp cloth. They should then be rinsed with clean water, again using a soft, damp cloth.

» Polishes will reduce anti-slip properties and solvent cleaners are not suitable.