

PROPASSO (SERIES C)

Polished, Brushed Finish and PVD Colored
(stainless steel AISI 304 and 316)

KALLOS PROPASSO (KPPOC) is a contemporary design Stainless Steel Step edge profile with a unique serrated grip edge. Providing edge protection to the floor covering and highlighting the step edge. The flange sits underneath the tile and the face section covers the exposed edge of the riser tile and prevents water ingress into the joint gap. These profiles offer superb resistance to principal chemical and atmospheric agents and are particularly recommended to protect edges in zones such as food processing industries, breweries, dairies, hospitals and external applications and wet area. Its smooth and non-porous surface makes it especially difficult for the adhesion and survival of bacteria and/or other microorganisms.
KALLOS Stainless Steel profiles Supplied with protection film for added protection, before, during and after application - as standard.

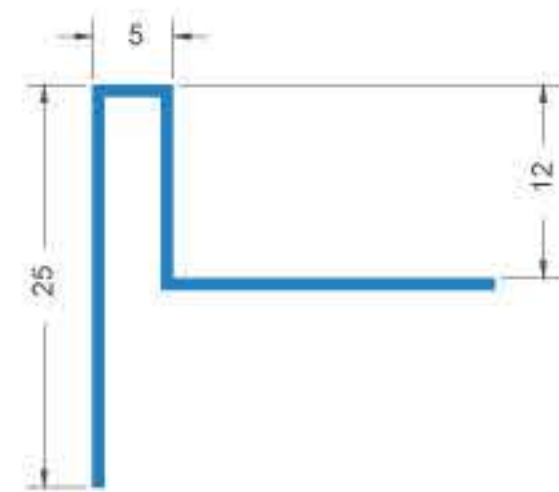

KPPOC-XX-12

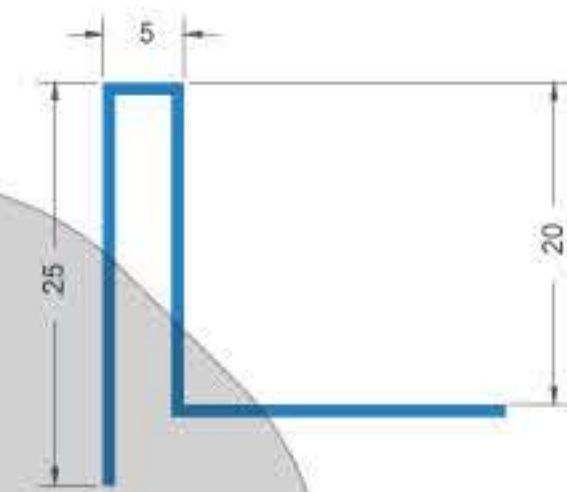

KPPOC-XX-20



Polished, Brushed and PVD Finish Stainless steel

AISI 304 and 316 with protection film - bar
length 2.44 meter
Size can be customized *

ARTICLE	H (mm)	L (m)
KPPOC-XX-12	12	2.44
KPPOC-XX-20	20	2.44

» When ordering specify the stainless steel grade as 304 or 316 for example: KPPOC-PS-12-XXX - the XXX stand as the grade of stainless steel

» When ordering specify the color for example: KPPOC-XX-12-316 - the XX stand as the profile color which can be selected from the color chart below.

Laying instructions

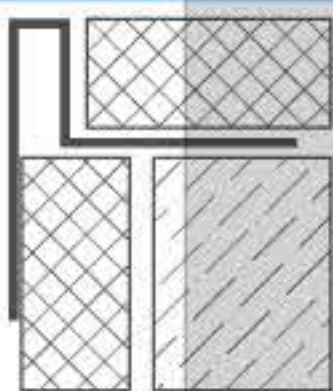

- 1 Check the fit of the nosing and ensure the profile is the correct height and width for the step and floorcovering.
- 2 Install the floorcovering on the riser.
- 3 Place the nosing firmly on the step and if necessary mark the floor.
- 4 Drill and Plug the floor if Mechanically fixing.
- 5 Apply the adhesive using a suitable notched trowel to the manufacturers recommendations.
- 6 Bed the profile into the adhesive ensuring that the adhesive comes through all the flange holes, spread the adhesive over the top of the flange before installing tiles.
- 7 A grout gap is not required however if visible ensure that grout is compressed firmly within the gap.

Colors



General Cleaning and Maintenance

» Do not use steel wool or sandpaper, or mineral acids, bleaches or chlorine cleansers.
» Do not add chlorine to your pool right next to your stainless steel Add it as far away as possible.
» Do not store stainless steel in a closed area underneath steel beams to avoid corrosive condensation from dripping onto the equipment and leaving brown spots.
» Do not store stainless steel where it will attract and retain moisture or airborne contaminants and do not store equipment in the same areas as chlorine.

» Rinse off stainless steel when exposed to Chlorine frequently with fresh water to wash away accumulated chemicals such as chlorine and wipe dry with a clean cloth. Especially try to clean immediately after use around chlorides (chlorine powder, seawater, etc.)
» Clean frequently with a cleaner and water. Any cleaner that is safe for glass is usually safe for stainless steel. Inspect frequently, if you notice discoloration, tarnish or water stains, increase the frequency of your fresh water rinses to reduce accumulated chemicals.
» Remove any rust spots as soon as possible to prevent irreversible pitting.
» Occasionally clean with borax, soda ash, or a non-abrasive commercial cleanser and water.
» Stubborn Stains may be removed with a magnesium oxide, ammonia and water paste.

* Size can be customized, Production upon request, timing and price to be agreed